

SCHEDULE	
Sales Area	1408 m ²
Warehouse g/a inc freezer/chiller	475 m ²
Ancillary g/a inc welfare & bakery	227 m ²
Internal walls	67 m ²
GIA LIA	2177 m ²
GF OFFICE ACCOMMODATION (PRIMARY)	162 m ²
FF OFFICE ACCOMMODATION (PRIMARY)	2274 m ²
GIA OFFICE (PRIMARY)	2436 m ²
GF OFFICE ACCOMMODATION (SECONDARY)	313 m ²
FF OFFICE ACCOMMODATION (SECONDARY)	313 m ²
GIA OFFICE (SECONDARY)	626 m ²
TOTAL OFFICE ACCOMMODATION	3062 m ²

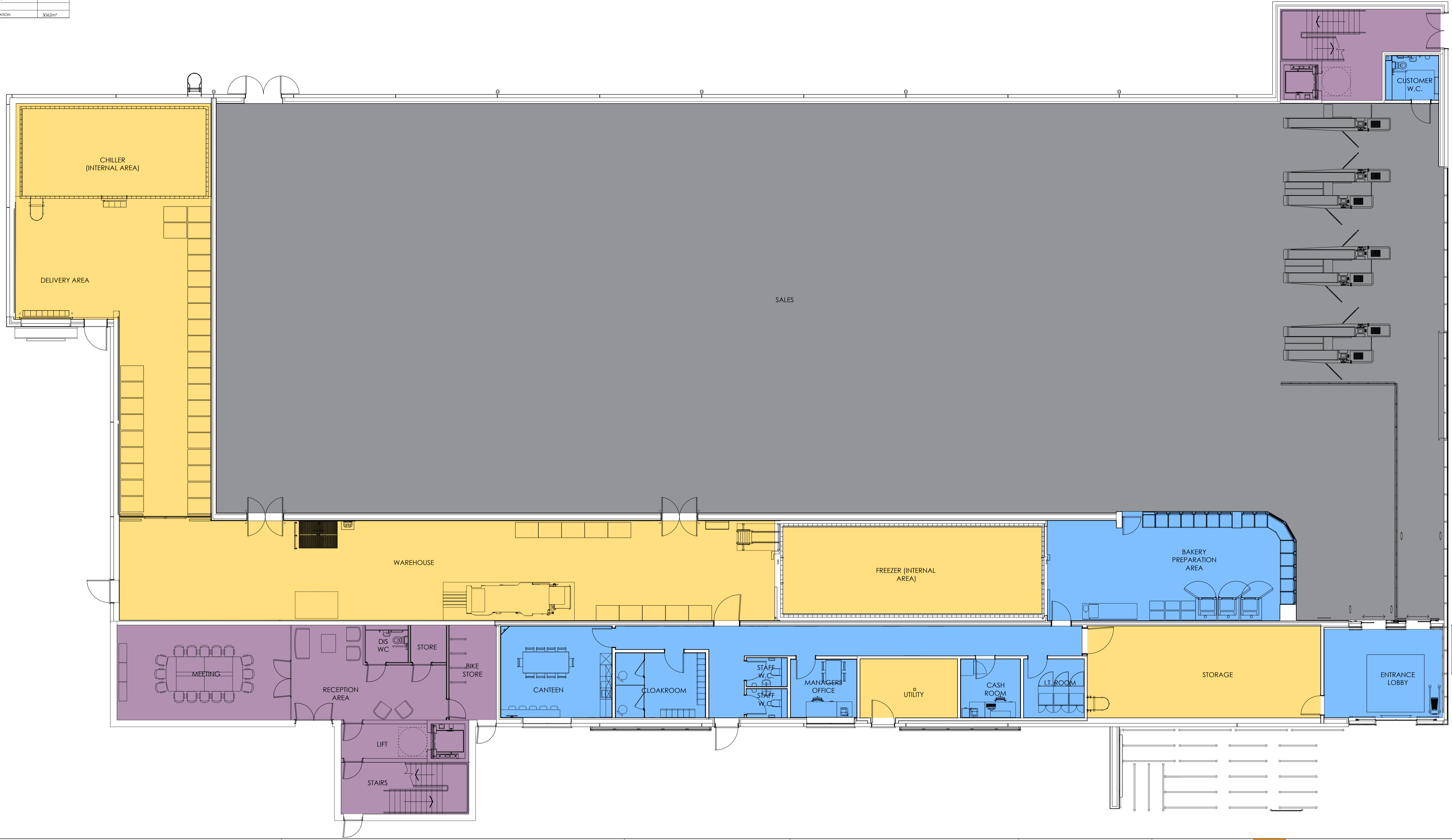

IMPORTANT INFORMATION
 Dimensions to be confirmed on site prior to start of works and ODAS to be informed of discrepancies immediately. No dimensions to be scaled from this drawing.
 All materials and works are to be carried out in accordance with current British Standards, Planning Approval, current Building Regulations and Codes of Practice.
 Party Wall Act - Notices under the Party Wall Act are to be served by the property owner or appointed third party by property owner.
 Health and Safety - CDM 2015 Regulations apply to all construction works to be carried out and apply to designers, contractors and the client. As such all parties have duties under these regulations.

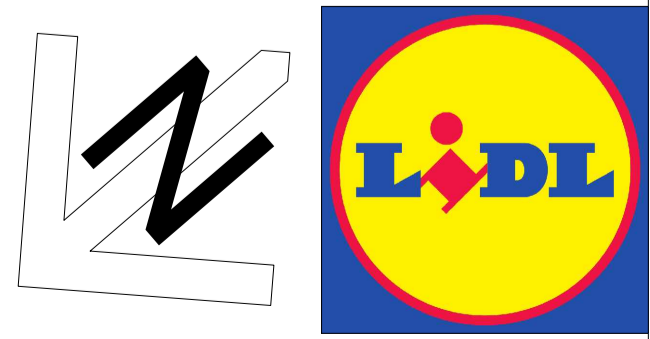

Rev	Date	Description	Revised By	Checked By
Revisions				

Client:
 LIDL GREAT BRITAIN LTD
 1ST FLOOR, 807-829 LONGBRIDGE ROAD, DAGENHAM, ESSEX, RM8 2DB.
Project Name:
 FOOTSCRAY HIGH STREET, SIDCUP, KENT, DA14 5HJ
Drawing Title:
 PROPOSED GROUND FLOOR PLAN
Drawing Status: PLANNING

Project No: 19208
Drawing No: AD 211
Drawn By: PAH
Checked By: LMC
Date: DEC 2020
Scale @ A1: 1:100

ONE DESIGN
 ARCHITECTURAL SERVICES

One Design Architectural Services Ltd
 Unit 1 Merchants Quay,
 Phase II, Ashley Lane, Shipley,
 West Yorkshire, BD17 7DB
 Tel: 01274 591188
 www.onedesignarchs.com
 mail@onedesignarchs.com
 Registered in England & Wales No: 8355643

Notes